

FITTING INSTRUCTION

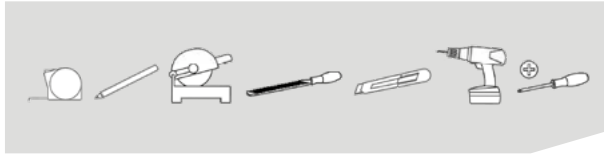

TOOLS REQUIRED

- / tape measure
- / pencil
- / circular saw or appropriate cutting tool
- / file
- / cutter
- / electric drill
- / screw driver

VALID FOR:

AS 2519 S

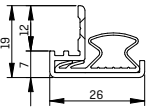

INSTRUCTIONS:

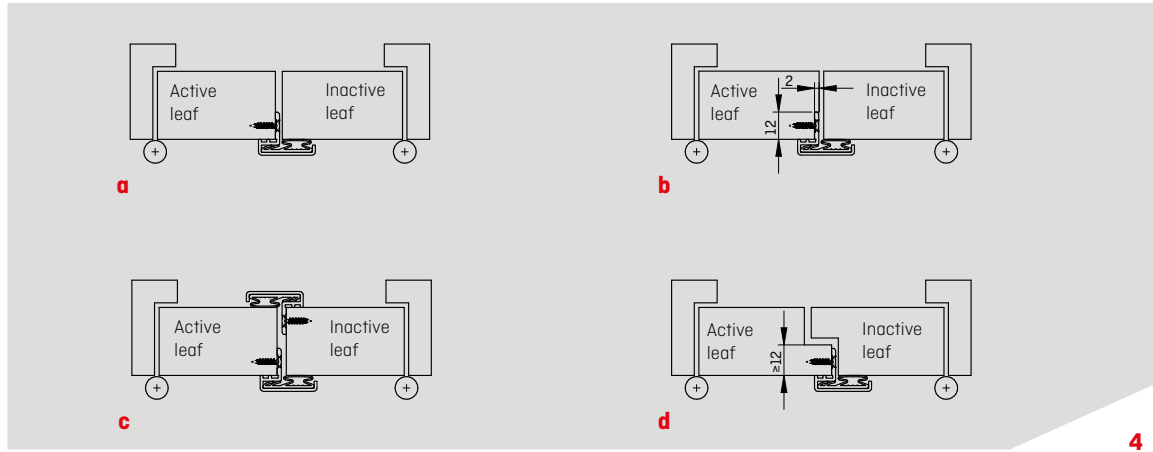
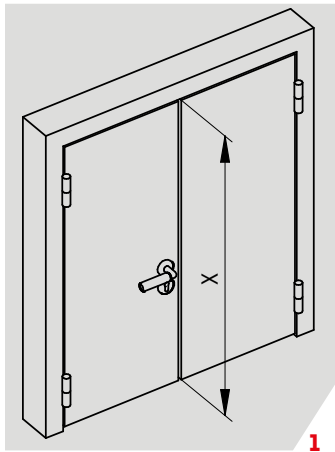

- 1 Measure the height of the meeting stile (x) and mark the required length on the AS 2519 S carrier profile.
- 2 Pull the gasket back beyond the cut mark and cut the carrier profile. File off the cutting burr and any sharp edges.
- 3 Reinsert the gasket and cut it to the same length as the carrier profile.
- 4 Screw fix the AS 2519 S to the door using the screws provided. Ensuring screw heads are flush with the carrier profile. If required, pre-drilling can be done with a 2 mm drill bit. Various installation positions are possible, the most common being on the opening face of the active leaf:
 - a) surface mounted
 - b) mounted into a groove
 - c) mounted on both sides
 - d) options a), b) and c) are also suitable for rebated doors
- 5 Close the door and check for uniform sealing along the long edge of the opposite leaf.

NOTE:

- / a sequential control (door co-ordinator) is recommended and mandatory for fire door applications
- / suitable for installation on new doors as well as for retro-fitting on existing doors
- / designed to seal gaps of up to 4.5 mm in the meeting stile
- / the AS 2519 S gasket should not be stretched
- / make sure the fitting of the AS 2519 S does not obstruct the function of the door. It is recommended to regularly check if the door opens and closes frictionlessly.